

VIEW A

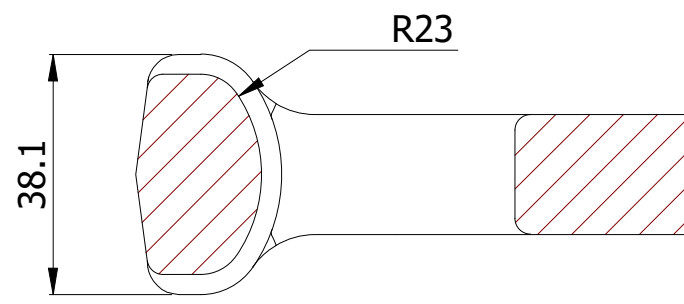

SECTION B-B

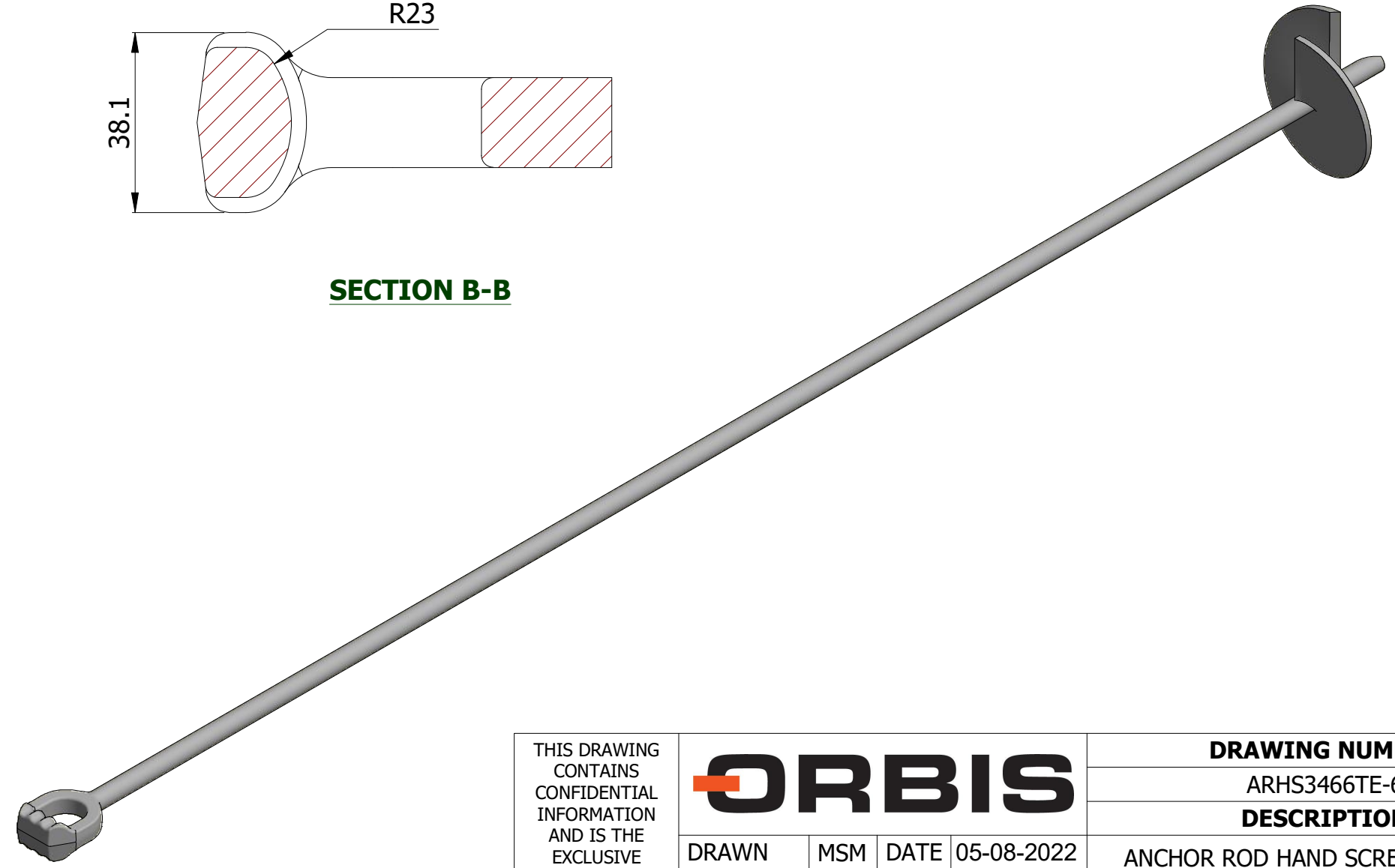
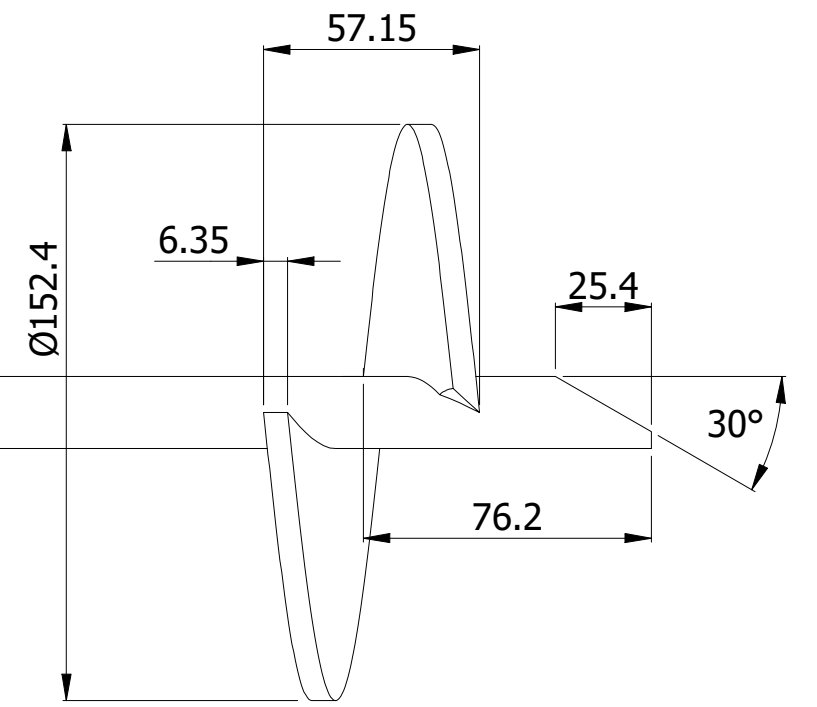

- NOTE:-
1. FINISH - HOT DIPPED GALVANIZED AS PER ASTM A-153
 2. INSTALLATION TORQUE - 400 FT-LBS

THIS DRAWING
CONTAINS
CONFIDENTIAL
INFORMATION
AND IS THE
EXCLUSIVE
PROPERTY OF
ORBIS
MANUFACTURING



DRAWN	MSM	DATE	05-08-2022
APPROVED	DMM	DATE	12-08-2022
REVISION	-		

DRAWING NUMBER
ARHS3466TE-6
DESCRIPTION
ANCHOR ROD HAND SCREW 3/4 X 66" HELIX 6" TRIPLE EYE THIMBLE