

- NOTES:
1. HOT DIP GALVANIZED PER ASTM A-153.
 2. SHAFT MATERIAL - HOT ROLLED RCS (ROUND CORNERED SQUARE) SOLID STEEL BARS; MINIMUM YIELD STRENGTH 90KSI.
 3. MINIMUM TENSILE STRENGTH - 70 KIP.
 4. PULLING EYE RATED 12,000 LBS.
 5. COMES WITH 3/4" X 3" A325 GALVANIZED STRUCTURAL BOLT AND 3/4" A563 GRADE A GALVANIZED JAM NUT.
 6. SOCKET IS UPSET FORGED.
 7. ALL DIMENSIONS ARE IN INCHES UNLESS OTHER SPECIFIED.

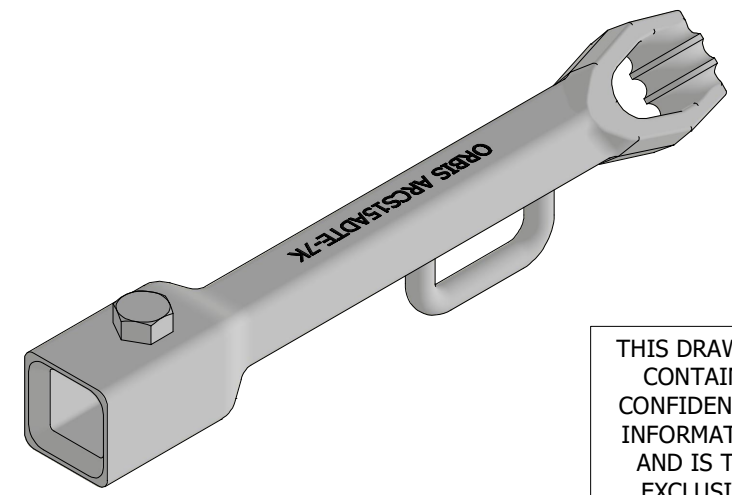

THIS DRAWING CONTAINS CONFIDENTIAL INFORMATION AND IS THE EXCLUSIVE PROPERTY OF ORBIS MANUFACTURING	ORBIS				DRAWING NUMBER	
					ARCS15ADTE-7K	
					DESCRIPTION	
DRAWN	MSM	DATE	02-02-2023	ANCHOR ADAPTER TRIPLE EYE THIMBLE 18" 7K FT-LB 70K LBS TENSILE INCL 12K LBS EYE 1.5" RCS SHAFT		
APPROVED	DMM	DATE	12-02-2023			
REVISION	DMM	R2	06-04-2024			